

# INTERACTIVE ASSIST

Interactive Assist from Quantum Rehab® is a new app which provides a direct real-time connection from a power chair's electronics to a provider's programming station. The connection provides the technician with full system and diagnostics information along with tools, such as a real-time mirror image of the power chair's electronics display, to aid in reducing service trips.



**Eliminate  
Wasteful Trips**



Save time and money...

- Reduce trips to client's home.
- Find detailed diagnostic information.



Real-time monitoring and mirroring.



Assists with programming chairs (must be performed using a programming station with a technician onsite).



Communicate with client via text chat.

Interactive Assist's  
chat screen shown  
on the iPhone

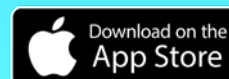
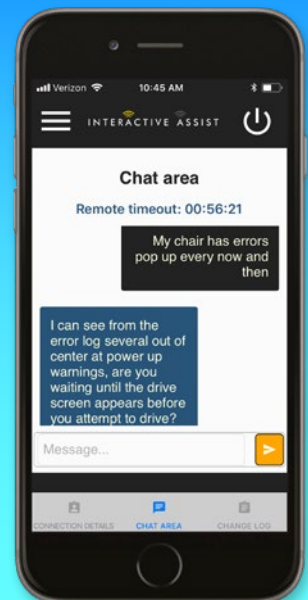

**QUANTUM**® 866-800-2002 | [quantumrehab.com](http://quantumrehab.com)

